

TECHNICAL SPECIFICATIONS

ADT-ID650-HB

65" Indoor Large Format – High Brightness



OVERVIEW

Advanced Display Technology is a bespoke display manufacturer working to deliver high quality, reliable, cost competitive products widely used across a range of market segments such as Retail, DOOH, QSR and Transport.

Our displays include PCAP touch screens with optional built in PC's, open frame designs and our larger range from 32" upwards to 65" offer slot-in OPS functionality.

Working with integrators to design products that fit practically into many environments ensure our displays are fit for purpose, supporting 24/7 use with a UK based warranty.

We are committed to delivering and designing market leading displays and use highly accredited manufacturing facilities with the minimum of the following accreditation's ISO9001, CE, FCC and RoHS.

KEY FEATURES

- 65" large format screen
- 3000 nits
- 4K resolution
- Wide operating temperature

65" INDOOR LARGE FORMAT – HIGH BRIGHTNESS

| Panel | |
|---------------------|------------------------|
| Active Display Area | 1431.4mm x 806.4mm |
| Backlight | Direct LED |
| Resolution | 3840 x 2160 |
| Brightness | 3000 cd/m ² |
| Contrast Ratio | 1200 : 1 |
| Viewing Angle | 89/89/89/89 |
| Display Colours | 16.7 M |

| Connectivity | |
|-------------------|--------------------------------|
| Video Input | 2 x HDMI |
| Audio Output | 3.5mm audio jack |
| Speakers | 2 x 3 watt |
| USB | 1 x USB2.0 |
| External Controls | Remote control |
| System on Chip | Optional built in media player |

Dimension Drawing (mm)

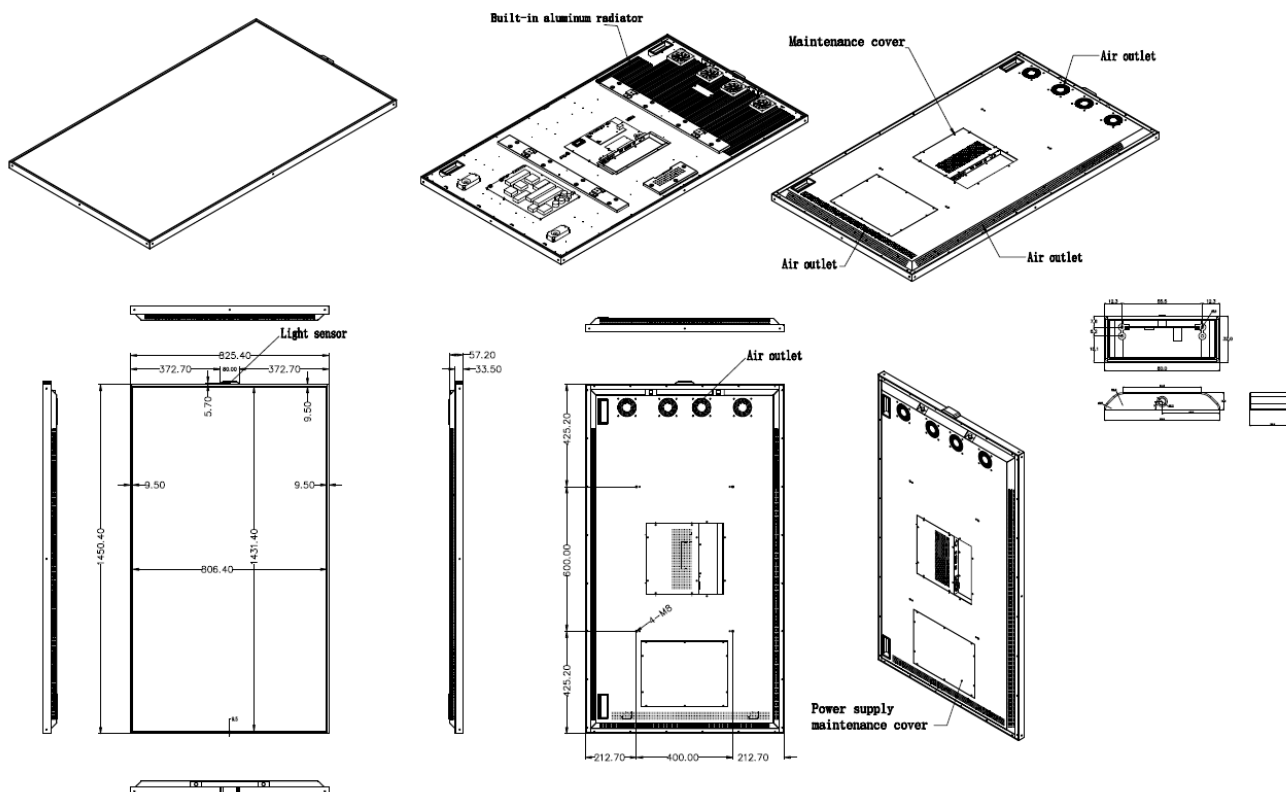

| Mechanical Structure | |
|-----------------------|--|
| Dimensions | 1450.4mm (Width) x 825.4mm (Height) x 57.2mm (Depth) |
| Net Weight | ~ 32kg |
| Finish | Zinc power coating + fine grain powder coating |
| Operating Temperature | Operating : -10°C to +60°C |
| Operating Humidity | 10% ~ 90% |
| Power Input | 100 – 240 VAC, 50-60Hz |
| Power (max) | 470 watts |
| Power (typical) | 240 watts |
| Mounting Arrangement | VESA 600 x 400 |

| Additional Features | |
|-----------------------|--------------------------------|
| Light Sensors | Automatic with manual override |
| Brightness Scheduling | Yes |
| Cooling | Built in fan with heat sink |
| Heat Sensor | Yes – with cloud server upload |
| Case Material | Metal |
| Case Colour | Black |
| Certifications | CE, FCC & RoHS |